

MINIATURE BALL BEARINGS— 600 Series(Metric)

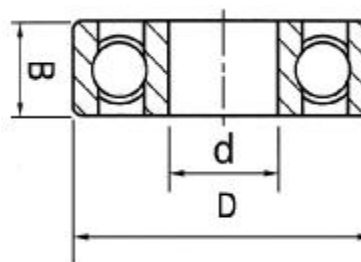

Bearing Number	Bore(d) mm	OD(D) mm	Width (B)		Flange Dimensions		Radius r	Basic Load Rating(lbs)		Weight (lbs.)
			Open	Shielded	Df	Open Wf		Dy. (C)	Sta. (Co)	
682	2	5	1.5	2.3	6.1	0.5	0.2	29	11	--
683	3	7	2	3	8.1	0.5	0.3	35	13	0.001
693	3	8	3	4	9.5	0.7	0.3	64	24	--
603	3	9	3	--	--	--	0.3	99	42	0.002
623	3	10	4	4	11.5	1.0	0.3	110	48	0.003
684	4	9	2.5	4	10.3	0.6	0.3	81	37	0.001
694	4	11	4	4	12.5	1.0	0.3	123	57	0.004
604	4	12	4	4	13.5	1.0	0.4	167	77	0.005
624	4	13	5	5	15	1.0	0.4	224	108	0.007
634	4	16	5	5			0.3	300	140	0.011
685	5	11	3	5	12.5	0.8	0.3	123	57	0.003
695	5	13	4	4	15	1.0	0.4	187	90	0.005
605	5	14	5	5	16	1.0	0.4	229	110	0.007
625	5	16	5	5	18	1.0	0.3	300	140	0.010
635	5	19	6	6			0.3	400	190	0.017
686	6	13	3.5	5	15	1.0	0.3	187	90	0.004
696	6	15	5	5	17	1.2	0.4	231	110	0.009
606	6	17	6	6	19	1.2	0.5	339	163	0.013
626	6	19	6	6	22	1.5	0.5	400	190	0.017
636	6	22	7	7						0.004
687	7	14	3.5	5	16	1.0	0.3	202	103	0.004
607	7	19	6	6			0.3	385	180	0.018
627	7	22	7	7			0.3	580	290	0.024
637	7	26	9	9						
688	8	16	4	5	18	1.0	0.3	235	120	0.007
698	8	19	6	6	22	1.5	0.3	285	145	
608	8	22	7	7	25	1.5	0.3	580	290	0.024
628	8	24	8	8			0.3	690	350	0.026
638	8	28	8	9						
689	9	17	4	5	19	1.0	0.3	229	128	0.013
699	9	20	6	6			0.3	310	160	
609	9	24	7	7			0.3	580	280	0.026

BALL BEARINGS— R- Series(Inch)

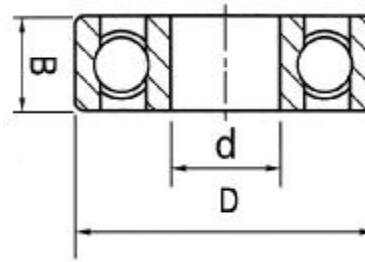

Bearing Number	Bore(d) inch	OD(D) inch	Width				Flange Dimensions		Basic Load Rating (lbs.)		Weight (lbs.) (Open)
			B (inch)		Bi (inch)		Df	Open Wf	Dynamic C	Static Co	
			Open	Shielded	Open	Shielded					
R09	1/25	1/8	0.0469						11	3	
R0	3/64	5/32	0.0625	0.0937	0.0937	0.1250	0.203	0.013	15	6	
R1	0.0550	3/16	0.0781	0.1094	0.1094	0.1406	0.234	0.023	26	10	
R1-4	5/64	1/4	0.0937	0.1406	0.125	0.1719	0.296	0.023	35	13	
R133	3/32	3/16	0.1875	0.0625	0.0937	0.1250	0.234	0.018	22	8	
R1-5	3/32	5/16	0.3125	0.1094	0.1406	0.1719	0.359	0.023	64	24	0.001
R144	1/8	1/4	0.0937	0.1094	0.125	0.1406	0.296	0.023	35	13	
R2-5	1/8	5/16	0.1094	0.1406	0.1406	0.1719	0.356	0.023	64	24	0.002
R2-6	1/8	3/8	0.1094	0.1406	0.1406	0.1719	0.422	0.023	73	29	0.002
R2	1/8	3/8	0.1562	0.1562	0.1875	0.1875	0.440	0.030	73	29	0.003
R2A	1/8	1/2	0.1719	0.1719					73	29	0.007
R155	5/32	5/16	0.1094	0.1250	0.1406	0.1562	0.359	0.023	42	18	0.001
R156	3/16	5/16	0.1094	0.1250	0.1406	0.1562	0.359	0.023	42	18	0.001
R166	3/16	3/8	0.1250	0.1250	0.1562	0.1562	0.422	0.023	81	33	0.002
R3	3/16	1/2	0.1562	0.1960	0.2272	0.2272	0.565	0.042	147	64	0.005
R3A	3/16	1/2	0.1960	0.1960					147	64	0.006
R168	1/4	3/8	0.1250	0.1250	0.1562	0.1562	0.422	0.023	42	20	0.001
R188	1/4	1/2	0.1250	0.1875	0.1562	0.2188	0.547	0.023	123	55	0.004
R4	1/4	5/8	0.1960	0.1960	0.2272	0.2272	0.690	0.042	167	77	0.010
R4A	1/4	3/4	0.2188	0.2812					403	198	0.017
R6	3/8	7/8	0.2188	0.2812			0.969	0.062	575	304	0.024
R8	1/2	1-1/8	0.2500	0.3125			0.225	0.062	880	505	0.039
R10	5/8	1-3/8	0.2812	0.3438					1036	624	0.081
R12	3/4	1-5/8	0.3125	0.4375					1630	1000	0.104
R14	7/8	1-7/8	0.3750	0.5000					1740	1111	0.157
R16	1	2	0.3750	0.5000					1850	1222	0.187
R18	1-1/8	2-1/8	0.3750	0.5000					2150	1407	0.198
R20	1-1/4	2-1/4	0.3750	0.5000					2420	1690	0.209
R22	1-3/8	2-1/2	0.4375	0.5625					2755	1910	0.232
R24	1-1/2	2-5/8	0.4375	0.5625					2906	2085	0.309

BALL BEARINGS—6000, 6200, 6300 Series

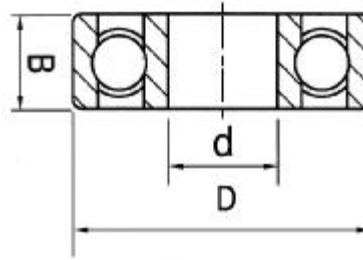

Bearing Number	Dimensions(mm)			Basic Load Rating		Limiting Speed		Single Weight (Kg)
	d	D	B	Cr (N)	Cor(N)	Grease Lub.	Oil Lub.	
6000	10	26	8	4550	1970	19000	36000	0.019
6001	12	28	8	5100	2390	17000	32000	0.023
6002	15	32	9	5600	2840	14000	28000	0.032
6003	17	35	10	6000	3250	13000	25000	0.039
6004	20	42	12	9400	5000	11000	21000	0.070
6005	25	47	12	10100	5850	9500	18000	0.079
6006	30	55	13	13200	8300	8000	15000	0.117
6007	35	62	14	16000	10300	7000	13000	0.156
6008	40	68	15	16800	11500	6500	12000	0.194

6200	10	30	9	5100	2390	17000	30000	0.032
6201	12	32	10	6800	3050	15000	27000	0.037
6202	15	35	11	7650	3700	13000	24000	0.045
6203	17	40	12	9550	4800	12000	21000	0.065
6204	20	47	14	12800	6600	10000	18000	0.106
6205	25	52	15	14000	7900	8500	16000	0.128
6206	30	62	16	19500	11300	7500	13000	0.199
6207	35	72	17	25700	15300	6300	11000	0.288
6208	40	80	18	29100	17900	5600	10000	0.366

6300	10	35	11	8100	3450	15000	26000	0.053
6301	12	37	12	9800	4250	14000	24000	0.060
6302	15	42	13	11400	5400	12000	20000	0.082
6303	17	47	14	13600	6550	11000	18000	0.115
6304	20	52	15	15900	7900	9500	16000	0.144
6305	25	62	17	23600	12100	7500	14000	0.232
6306	30	72	19	26700	15000	6300	11000	0.346
6307	35	80	21	33500	19100	6000	1000	0.457
6308	40	90	23	40500	24100	5000	9000	0.633
6309	45	100	25	53000	32000	4500	8000	0.833
6310	50	110	27	62000	38100	4300	7300	1.070

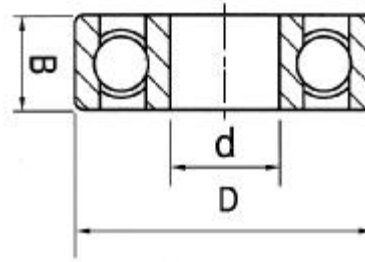

6400 Series

Bearing Number	Dimensions			Basic Load Rating		Limiting Speed		Single Weight (Kg)
	d	D	B	Cr (N)	Cor(N)	Grease Lub.	Oil Lub.	
6403	17	62	17	22700	10800	12000	15000	0.271
6404	20	72	19	31000	15200	11000	13000	0.408
6405	25	80	21	40000	20100	9500	11000	0.528
6406	30	90	23	43500	23800	8500	9500	0.720
6407	35	100	25	55000	31000	7000	8500	0.936
6408	40	110	27	63500	36500	6500	8000	1.200
6409	45	120	29	77500	45000	6000	7200	1.550
6410	50	130	31	87500	52000	5500	6500	1.910
6411	55	140	33	101000	62000	5000	6000	2.320
6412	60	150	35	109000	70000	4500	5500	2.790
6413	65	160	37	118000	78500	4500	5200	3.360

62200 Series

Bearing Number	Dimensions			Basic Load Rating		Limiting Speed		Single Weight (Kg)
	d	D	B	Cr (N)	Cor(N)	Grease Lub.	Oil Lub.	
62200	10	30	14	5100	2390	17000	30000	0.044
62201	12	32	14	6800	3050	15000	27000	0.053
62202	15	35	14	7650	3700	13000	24000	0.065
62203	17	40	16	9550	4800	12000	21000	0.096
62204	20	47	18	12800	6600	10000	18000	0.145
62205	25	52	18	14000	7900	8500	16000	0.172
62206	30	62	20	19500	11300	7500	13000	0.245
62207	35	72	23	25700	15300	6300	11000	0.381
62208	40	80	23	29100	17900	5600	10000	0.460
62209	45	85	23	32500	20500	5100	9300	0.488
62210	50	90	23	35000	23200	4800	8600	0.526
62211	55	100	25	43500	29300	4400	7700	0.713
62212	60	110	28	52500	36000	4000	7100	0.983



6800 series

Bearing Number	Dimensions(mm)			Basic Load Rating		Limiting Speed		Single Weight (Kg)
	d	D	B	Cr (N)	Cor(N)	Grease Lub.	Oil Lub.	
6800	10	19	5	1840	925	37000	44000	0.005
6801	12	21	5	1900	1040	32000	39000	0.006
6802	15	24	5	2080	1260	27000	32000	0.007
6803	17	26	5	2630	1570	25000	30000	0.008
6804	20	32	7	4000	2470	20000	24000	0.019
6805	25	37	7	4300	2950	18000	20000	0.022
6806	30	42	7	4500	3400	15000	17000	0.026
6807	35	47	7	4900	4000	13000	15000	0.029
6808	40	52	7	5050	4350	12000	14000	0.033

6900 series

6900	10	22	6	2700	1270	33000	38000	0.009
6901	12	24	6	2900	1460	30000	35000	0.011
6902	15	28	7	4300	2250	26000	31000	0.016
6903	17	30	7	4600	2550	24000	29000	0.018
6904	20	37	9	6350	3700	19000	23000	0.036
6905	25	42	9	7000	4500	16000	20000	0.041
6906	30	47	9	7250	5000	14000	16000	0.045
6907	35	55	10	10400	7150	12000	14000	0.073
6908	40	62	12	13700	9900	11000	13000	0.109

16000 series

16001	12	28	7	5100	2370	28000	32000	0.019
16002	15	32	8	5600	2840	23000	28000	0.025
16003	17	35	8	6000	3250	20000	24000	0.032
16004	20	42	8	7900	4500	17000	21000	0.050
16005	25	47	8	6950	5650	15000	18000	0.060
16006	30	55	9	9550	6550	12000	15000	0.085
16007	35	62	9	11700	8150	11000	13000	0.110
16008	40	68	9	12600	8550	9700	12000	0.125

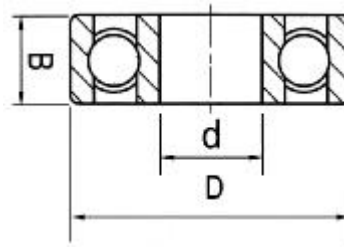

RLS series

Bearing Number	Dimensions			Basic Load Rating		Limiting Speed		Single Weight (Kg)
	d	D	B	Cr (N)	Cor(N)	Grease Lub.	Oil Lub.	
RLS4	1/2	1-5/16	3/8	6890	3100	22000	28000	0.041
RLS5	5/8	1-9/16	7/16	9560	4500	17000	20000	0.059
RLS6	3/4	1-7/8	9/16	12700	6200	15000	18000	0.120
RLS7	7/8	2	9/16	15100	7500	14000	17000	0.120
RLS8	1	2-1/4	5/8	17800	8800	11000	14000	0.170
RLS9	1-1/8	2-1/2	5/8	19500	10000	10000	13000	0.220
RLS10	1-1/4	2-3/4	11/16	22500	11800	9500	12000	0.300

RMS series

RMS4	1/2	1-5/8	5/8	11400	5000	18000	22000	0.100
RMS5	5/8	1-13/16	5/8	13500	6550	16000	19000	0.120
RMS6	3/4	2	11/16	15900	7800	13000	16000	0.160
RMS7	7/8	2-1/4	11/16	18600	9150	12000	15000	0.210
RMS8	1	2-1/2	3/4	22500	11400	11000	14000	0.270
RMS9	1-1/8	2-13/16	13/16	28100	14600	9000	11000	0.370
RMS10	1-1/4	3-1/8	7/8	33200	18000	8500	10000	0.500

1600 Series

1607	7/16	29/32	5/16	3560	1950	18000	32000	0.0160
1614	3/8	1-1/8	3/8	5110	2390	17000	32000	0.0286
1615	7/8	1-1/8	3/8	5110	2390	17000	32000	0.0267
1616	1/2	1-1/8	3/8	5110	2390	17000	32000	0.0247
1620	7/16	1-3/8	7/16	7640	3720	13000	25000	0.0520
1621	1/4	1-3/8	7/16	7640	3720	13000	25000	0.0490
1622	9/16	1-3/8	7/16	7640	3720	13000	25000	0.0464
1623	5/8	1-3/8	7/16	7640	3720	13000	25000	0.0432
1628	5/8	1-5/8	1/2	9570	4790	11000	21000	0.0788
1630	3/4	1-5/8	1/2	9380	5030	11000	21000	0.0779
1633	5/8	1-3/4	1/2	9380	5030	11000	21000	0.1000
1635	3/4	1-3/4	1/2	9380	5030	11000	21000	0.0914

DOUBLE ROW BALL BEARINGS

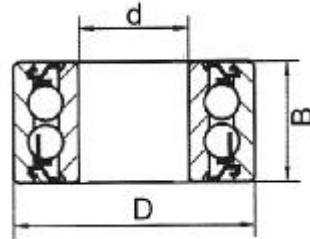

5200 Series

Bearing Number	Dimensions(mm)			Basic Load Rating		Limiting Speed		Single Weight (Kg)
	d	D	B	Cr (N)	Cor(N)	Grease Lub.	Oil Lub.	
5200	10	30	14.3	7150	3900	17000	22000	0.05
5201	12	32	15.9	10500	5800	15000	20000	0.06
5202	15	35	15.9	11700	7050	13000	17000	0.07
5203	17	40	17.5	14600	9050	11000	15000	0.09
5204	20	47	20.6	19600	12400	10000	13000	0.12
5205	25	52	20.6	21300	14700	8500	11000	0.19
5206	30	62	23.8	29600	21100	7100	9500	0.29
5207	35	72	27	39000	28700	6300	8000	0.43

5300 Series

5300	10	35	19	10570	5840	37000	44000	0.005
5301	12	37	19	13180	7450	32000	39000	0.006
5302	15	42	19	17600	10200	11000	15000	0.11
5303	17	47	22.2	21000	12600	10000	13000	0.14
5304	20	52	22.2	24600	15000	9000	12000	0.23
5305	25	62	25.4	32500	20700	7500	10000	0.34

NOTE: 3200 Series are available upon request.

1200 Series

1201	12	32	10	5600	1250	21000	26000	0.040
1202	15	35	11	7450	1750	18000	22000	0.060
1203	17	40	12	7900	2000	16000	20000	0.073
1204	20	47	14	9900	2600	13000	17000	0.120
1205	25	52	15	12100	3300	12000	14000	0.141
1206	30	62	16	15600	4650	10000	12000	0.220

1300 Series

1300	10	35	11	5690	1860	23000	27000	0.058
1301	12	37	12	9400	2150	19000	23000	0.067
1302	15	42	13	9550	2300	16000	20000	0.094
1303	17	47	14	12500	3200	14000	17000	0.130
1304	20	52	15	12400	3300	12000	15000	0.163
1305	25	62	17	18000	5000	10000	13000	0.257

ANGULAR CONTACT BALL BEARINGS

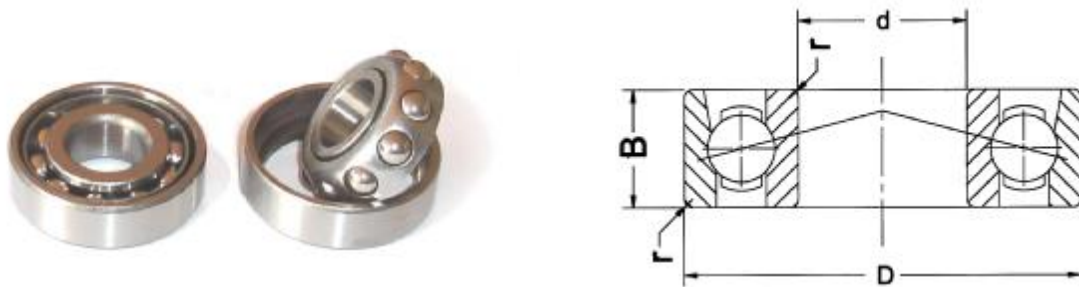

Angular contact ball bearings have raceways in the inner and outer rings which are displaced with respect to the direction of the bearing axis. These bearings are suitable for accommodation of combined loads, i.e. simultaneously acting radial and axial loads in one direction only. The amount of axial load the bearing can carry increases depending on the contact angle, the larger the contact angle is, the higher the axial load it can support.

Bearing Number	Dimensions (mm)			Weight Kg	Notes
	d	D	B		
7004□	20	42	12	0.070	1. $\alpha = 15^\circ$ □=C 2. $\alpha = 25^\circ$ □=AC 3. $\alpha = 40^\circ$ □=B α : CONTACT ANGLE
7005□	25	47	12	0.080	
7006□	30	55	13	0.120	
7007□	35	62	14	0.160	
7008□	40	68	15	0.195	
7009□	45	75	16	0.250	
7010□	50	80	16	0.270	
7204□	20	47	14	0.116	
7205□	25	52	15	0.144	
7206□	30	62	16	0.217	
7207□	35	72	17	0.312	
7208□	40	80	18	0.404	
7209□	45	85	19	0.456	
7210□	50	90	20	0.516	
7304□	20	52	15	0.159	
7305□	25	62	17	0.254	
7306□	30	72	19	0.383	
7307□	35	80	21	0.507	
7308□	40	90	23	0.695	
7309□	45	100	25	0.927	
7310□	50	110	27	1.200	

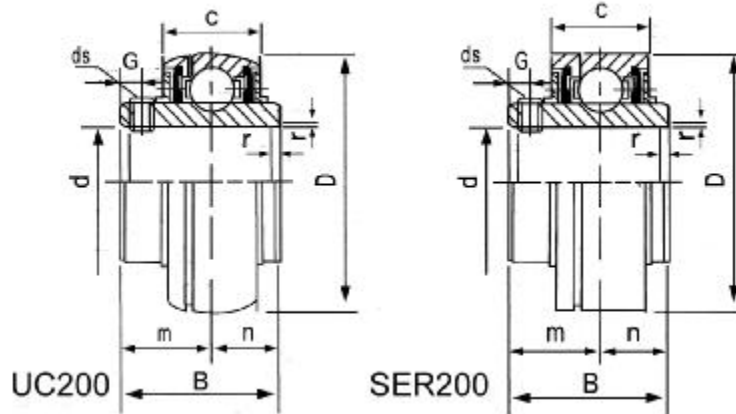

UC—Series

Bearing Number UC--	Shaft Diameter d		Dimensions (mm)							Basic Load Ratings (KN)		Weight (Kg)
	inch	mm	D	B	C	n	m	G	ds	Cr	Cor	
203 203-11	11/16	17	40	27.4	14	11.5	15.9	4.5	1/4-28UNF M5X0.8	9.57	4.79	0.16 0.15
204 204-12	3/4	20	47	31	16	12.7	18.3	5	1/4-28UNF M6X1	12.8	6.65	0.18 0.17
205 205-14 205-15 205-16	7/8 15/16 1	25	52	34.1	17	14.3	19.8	5.5	1/4-28UNF M6X1	14.0	7.88	0.20 0.23 0.21 0.20
206 206-18 206-19 206-20	1- 1/8 1- 3/16 1-1/4	30	62	38.1	19	15.9	22.2	6	1/4-28UNF M6X1	19.5	11.5	0.33 0.35 0.33 0.31
207 207-20 207-21 207-22 207-23	1-1/4 1-5/16 1-3/8 1-7/16	35	72	42.9	20	17.5	25.4	7.0	5/16-24UNF M8X1	25.5	15.2	0.49 0.55 0.52 0.49 0.46
208 208-24 208-25	1-1/2 1-9/16	40	80	49.2	21	19	30.2	8	5/16-24UNF M8X1	29.55	18.0	0.65 0.69 0.66
209 209-26 209-27 209-28	1-5/8 1-11/16 1-3/4	45	85	49.2	22	19	30.2	8	5/16-24UNF M8X1	31.5	20.5	0.74 0.84 0.80 0.76
210 210-30 210-31 210-32	1-7/8 1-15/16 2	50	90	51.6	24	19	32.6	10	3/8-24UNF M10X1.25	35.0	23.2	0.81 0.88 0.83 0.80

NOTE: **SER** series are available upon request.



INSERT BEARINGS— SA, SB Series

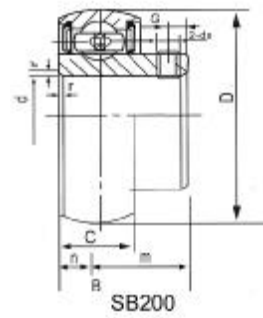
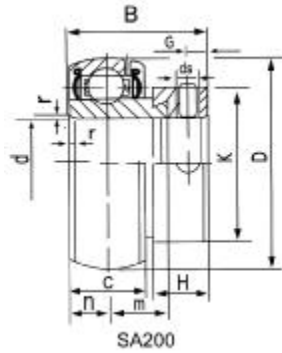

SA-- Series

Bearing Number SA--	Shaft Dia d		Dimensions (mm)										Basic Load ratings KN		Weight Kg
	in	mm	D	B	C	n	m	H	J	P	G	ds	Cr	Cor	
204-12 204	3/4	20	47	31	21.5	14	7.5	14	32	13.5	4.7	1/4-28UNF M6×1	12.8	6.65	0.15 0.14
205-14 205-15 205-16 205	7/8 15/16 1	25	52	31	21.5	15	7.5	14	38.1	13.5	5	1/4-28UNF M6×1	14.0	7.88	0.21 0.19 0.18 0.18
206-17 206-18 206-19 206-20 206	11/16 11/8 13/16 11/4	30	62	35.7	23.8	16	9	14.8	44.4	15.9	6	1/4-28UNF M6×1	19.5	11.5	0.35 0.33 0.31 0.29 0.29
207-20 207-21 207-22 207-23 207	11/4 15/16 13/8 17/16	35	72	38.9	25.4	17	9.5	15.9	55.6	17.5	7	5/16-24UNF M8×1	25.5	15.2	0.56 0.53 0.51 0.48 0.51
208-24 208-25 208	11/2 19/16	40	80	43.7	30.1	18	11	19.1	60.3	18.3	7	5/16-24UNF M8×1	29.5 5	18.0	0.68 0.65 0.64

SB-- Series

Bearing Number SB-	Shaft Dia d		Dimensions (mm)										Basic Load Ratings KN		Weight Kg
	in	mm	D	B	C	n	m	G	ds	Cr	Cor				
204-12 204	3/4	20	47	24.7	14	7	17.7	4.5	1/4-28UNF M6×1	12.8	6.65	0.13 0.12			
205-14 205-15 205-16 205	7/8 15/16 1	25	52	27	15	7.5	19.5	5	1/4-28UNF M6×1	14.0	7.88	0.18 0.17 0.16 0.16			
206-17 206-18 206-19 206-20 206	11/16 11/8 13/16 11/4	30	62	30.3	16	8	22.3	5	1/4-28UNF M6×1	19.5	11.5	0.28 0.26 0.24 0.23 0.23			
207-20 207-21 207-22 207-23 207	11/4 15/16 13/8 17/16	35	72	32.9	17	8.5	24.4	6.5	5/16-24UNF M8×1	25.5	15.2	0.43 0.41 0.38 0.37 0.37			
208-24 208-25 208	11/2 19/16	40	80	34	18	9	25	7.5	5/16-24UNF M8×1	29.55	18.0	0.60 0.58 0.57			

NOTE: **CSA, CSB** series are available upon request.

PILLOW BLOCKS— UCP Series

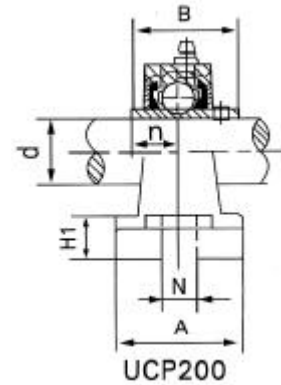
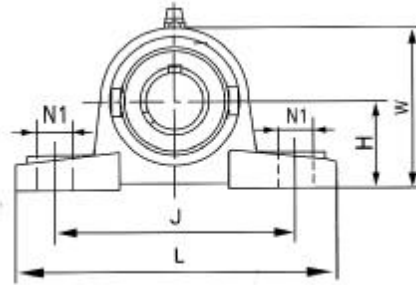

UCP-- Series

Bearing No.	Shaft Dia d		Dimensions (mm)											Bolt Size	Weight Kg
	in	mm	H	L	J	A	N	N1	H1	W	N	B	ds		
203 203-11	11/16	17	30.2	125	96	32	12	16	13	57	11.5	27.4	1/4-28UNF M5×0.8	M10	0.60
204-12 204	3/4	20	33.3	127	96	37	13	16	14	63.8	12.7	31	1/4-28UNF M5×0.8	M10	0.70
205014 205-15 205	7.8 15/16	25	36.5	140	105	38	13	19	15	69.5	14.3	34.1	1/4-28UNF M5×0.8	M10	0.75
205-16	1														
206-18 206	1-1/8	30	42.9	160	121	44	14	19	16	82	15.9	38.1	5/16-24UNF M8×1	M12	1.30
206-19 206-20	1-3/16 1-1/4														
207-20 207-21 207-22 207	1-1/4 1-5/16 1-3/8	35	47.6	167	126	48	15	19	17	92	17.5	42.9	5/16-24UNF M8×1	M12	1.60
207-23	1-7/16														
208-24 208-25 208	1-1/2 1-9/16	40	49.2	180	136	52	15	21	18	98	19	49.2	5/16-24UNF M8×1	M12	1.90
209-26 209-27 209-28 209	1-5/8 1-11/16 1-3/4	45	54	190	146	54	15	21	20	105.5	19	49.2	5/16-24UNF M8×1	M12	2.30
210-30 210-31 210 210-32	1-7/8 1-15/16	50	57.2	204	159	57	19	22	21	113	19	51.6	5/16-24UNF M8×1	M16	2.60

NOTE: 1. UCT, UCF, UCFC, UCFL, UCPA series are available upon request.

2. SAPP, SBPP, SAPF, SBPF, SAPFL, SBPFL, SAPFT, SBPFT series are available upon request.



WHEEL HUB BEARINGS



Bearing Number			Boundary Dimensions (mm)				Weight	Seal	Note
PEAK No.	KOYO No.	SKF No.	d	D	B	C	Kg		
DAC255200206		617546A	25	52	20.6	20.6	0.19	A	
DAC25520037		445539AA	25	52	37	37	0.31	C	
DAC28580042	DAC28582RK	28BW03A	28	58	42	42	0.45	C	&
DAC28610042	DAC286142AW		28	61	42	42	0.56	D	&
DAC30600037	DAC3060372RS		30	60	37	37	0.42	C	
DAC30600337	DAC3060W	BA2B633313C	30	60.03	37	37	0.42	C	
DAC30630342	DAC3063W-1		30	63.03	42	42	0.54	D	
DAC30640042	DAC3064W2RKB		30	64	42	42	0.55	C	&
DAC32730054	DAC3243W		32	73	54	54	0.98		
DAC32640034	DAC3464D		34	64	34	34	0.43	D	
DAC34640037	DAC3464G12RS	309726DA	34	64	37	37	0.43	B	&*
DAC34660037		636114A	34	66	37	37	0.5	C	&*
DAC34680037	DAC3468DW		34	68	37	37	0.55		
DAC34680042	DAC34682RS		34	68	42	42	0.64	B	&*
DAC35640037	DAC3564A-1		35	64	37	37	0.41	B	&*
DAC35650035		BT445620B	35	65	35	35	0.40	C	&
DAC35660033		BAHB633676	35	66	33	33	0.43	C	&
DAC35660037		BAHB311309	35	66	37	37	0.48	C	&
DAC35680037	DAC3568A2RS	BAHB633528F	35	68	37	37	0.52	C	
DAC35680233/30	DAC3568W-6		35	68.02	33	30	0.47	D	
DAC35720228		441832AB	35	72.02	28	28	0.49	D	&
DAC35720033		BA446762B	35	72	33	33	0.58	C	&
DAC35720034	DAC357234A		35	72	34	34	0.58	D	&
DAC35720433		BAHA633669	35	72.04	33	33	0.58	C	&
DAC35720233/31	DAC357233B-W		35	72.02	31	31	0.56	D	
DAC35720434			35	72.04	34	34	0.58	A,D	
DAC35770442	DAC3577W-3		35	77.04	42	42	0.86	D	
DAC35618031	DAC3562AW		35	61.8	31	31	0.35	D	
DAC35720045	DAC357245CW2RS		35	72	45	45	0.63	C	

&: The inner ring is locked. *: The outer ring has a lead lader.

WHEEL HUB BEARINGS



Bearing Number			Boundary Dimensions (mm)				Weight	Seal	Note
PEAK No.	KOYO No.	SKF No.	d	D	B	C	Kg		
DAC35800047	DAC358047BW2RS		35	80	47	47	0.96	C	
DAC35800045	DAC3580W-3HR4		35	80	45	45	1.10		
DAC36650037	DAC3665AW		36	65	37	37	0.45	D	
DAC36680033	DAC3668AW		36	68	33	33	0.47	D	
DAC36720534	DAC367234A		36	72.05	34	34	0.58	D	
DAC37720037			37	72	37	37	0.59	C	&*
DAC37720237		BA2B633028CB	37	72.02	37	37	0.59	C	&*
DAC37720437		633531B	37	72.04	37	37	0.59	C	&*
DAC38700038	DAC3870BW		38	70	38	38	0.55	B	&
DAC38720236/33	DAC3872W-3		37.99	72.02	36	33	0.54	D	
DAC38740233/33	DAC3874W-6		37.99	74.02	36	33	0.60	D	
DAC38740050			38	74	50	50	0.78	A	
DAC38710233/30	DAC3871W-2		37.99	71.02	33	30	0.50	D	
DAC38720034	DAC3872A		38	72	34	34	0.59	D	
DAC38720040	DAC3872W-10		38	72	40	40	0.63	B	
DAC38730040	DAC3873-1		38	73	40	40	0.67	B	
DAC39680037		BA2B309692	39	68	37	37	0.48	B	&*
DAC39680637			39	68.06	37	37	0.48	B	&*
DAC39680737			39	68.07	37	37	0.48	B	&*
DAC39720037	DAC3872AW4	BAHB311396B	39	72	37	37	0.56	B	*
DAC39720637			39	72.06	37	37	0.56	B	*
DAC40720037		BAHB311443B	40	72	37	37	0.56	C	&*
DAC40740036/34	DAC4074BW		40	74	36	34	0.58	D	&
DAC40750037	DAC4075	BAHB633966E	40	75	37	37	0.62	C	
DAC40760033/28		474743	40	76	33	28	0.54	A	&
DAC40800036/34	DAC4080MI		40	80	36	34	0.74	D	
DAC40700043/	DAC407043W		40	70	43	43	0.63	B	
DAC40720036/33	DAC4072		40	72	36	33	0.53	D	
DAC40740040	DAC407440		40	74	40	40	0.62	B	

&: The inner ring is locked. *: The outer ring has a lead lader.